



SANTA FE

Av. Vasco de Quiroga 1684, Col. 2da Amp El Pirú, Álvaro Obregón, 01240, México City

Interlogix Santa Fe

We develop and operate **Vertical Logistics Parks** in strategically located areas within Mexico City and the country's main cities.

Interlogix Santa Fe is located in the prestigious financial district of Santa Fe, in Mexico City. Our strategic location positions us as the epicenter of opportunities, providing us with the ability to offer an ideal environment for the growth and success of our tenants to address their last mile needs.

**building the future
of warehouses, for middle
& last mile distribution**

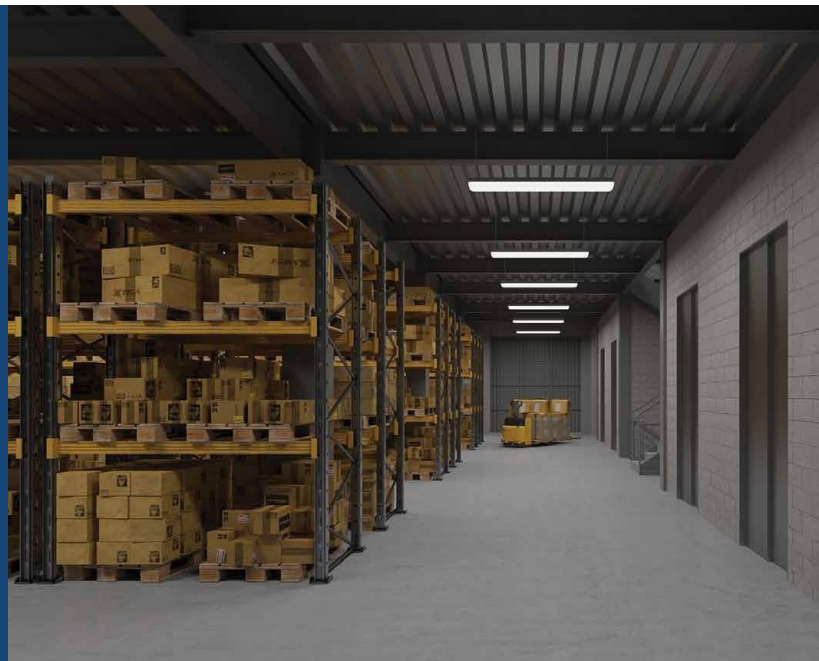

Main Features



63,000 SF
of leasable area
(5,853sqm)



14ft clear height
(4.35 m)



Spaces starting
from 4,068SF
(378 sqm)



6 floors of
leasable area



Typical floor plan

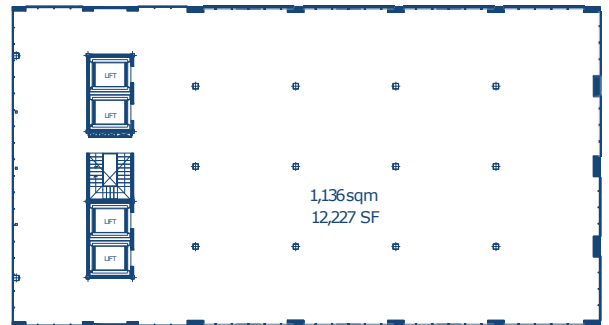

4 high-speed cargo lifts capable of carrying up to two tons



Renewable energy



Rainwater harvesting and reuse systems



Maneuvering yard with multiple dock positions for vehicles ranging from vans up to 53-foot trailers



Underground parking

Location

Santa Fe

México City

Nearby Zones - 5km Radius

- Santa Fe (todas las zonas)
- Lomas de Chapultepec
- Lomas Altas
- Lomas de Bezares
- Bosques de las Lomas
- Interlomas
- Lomas de Tecamachalco
- Lomas de la Herradura
- Lomas Anáhuac
- El Yaqui
- Lomas de Tarango
- 2da Amp El Pirú

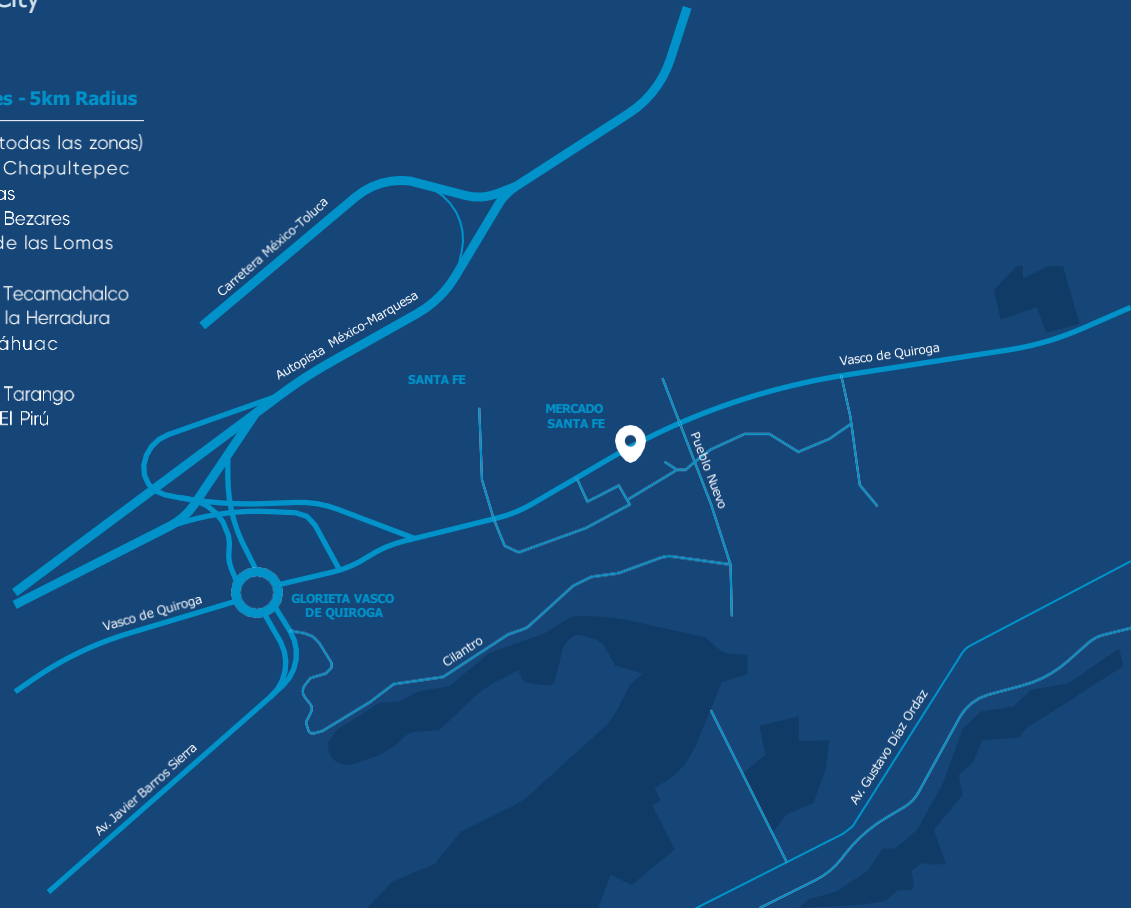

Contact

Interlogix

Fernando Garzón

fernando@interlogix.com.mx

Ph. +52 55 4162 1100

Av. Santa Fe 505 Piso 5

Cruz Manca, CDMX, 05349

México

interlogix.com.mx