

SANTA FE

SANTA FE

Vasco de Quiroga 1684, 2da Amp el Pirú, Álvaro Obregón, 01240, México City

BODEGAS DISPONIBLES
EN RENTA
DESDE 370 M2
5-2516 7804
interlogix.com.mx

Interlogix Santa Fe

We develop and operate **Vertical Logistics Parks** in strategically located areas within Mexico City and the country's main cities.

Interlogix Santa Fe is located in the prestigious financial district of Santa Fe, in Mexico City. Our strategic location positions us as the epicenter of opportunities, providing us with the ability to offer an ideal environment for the growth and success of our tenants to address their last mile needs.

**building the future
of warehouses, for middle
& last mile distribution**



Main Features



58,932 SF
of leasable area
(5,475 sqm)



14ft clear height
(4.35 m)



Spaces starting
from 6,114SF
(568 sqm)



5 floors of
leasable area



Typical floor plan & divided floor

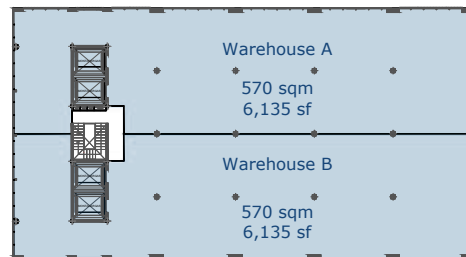
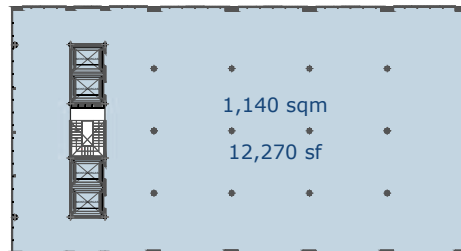

4 high-speed cargo lifts capable of carrying up to two tons each



Renewable energy



Rainwater harvesting and reuse systems



Maneuvering yard with multiple dock positions for vehicles ranging from vans up to 53-foot trailers



Underground parking

Location

Santa Fe

México City

Nearby Zones - 5km Radius

- Santa Fe (Todas las zonas)
- Lomas de Chapultepec
- Lomas Altas
- Lomas de Bezares
- Bosques de las Lomas
- Lomas de Tecamachalco
- Lomas de la Herradura
- Lomas Anáhuac
- El Yaqui
- Lomas de Tarango
- 2da Amp El Pirú

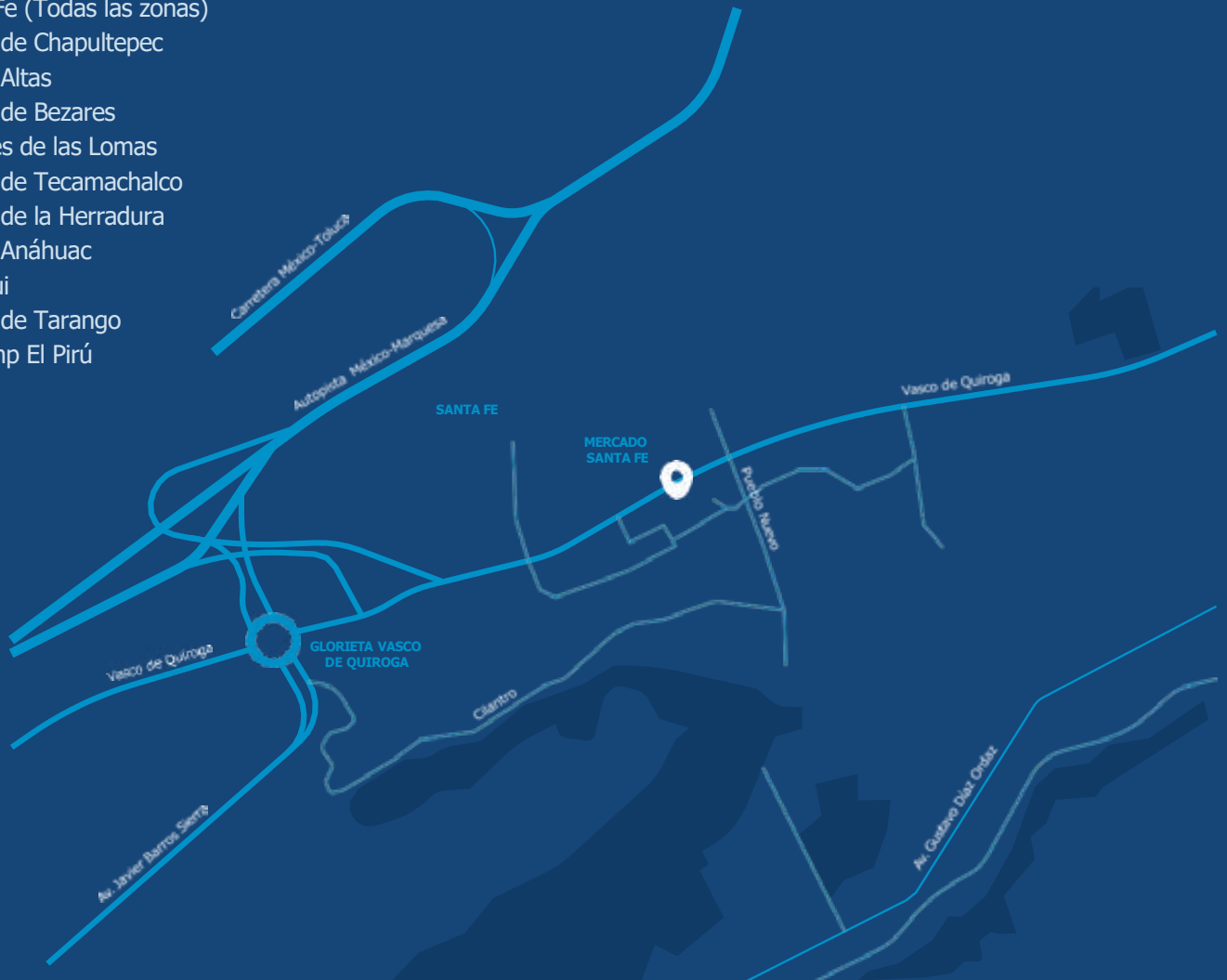

Contact

Interlogix

Fernando Garzón

fernando@interlogix.com.mx

Ph. +52 55 4162 1100

Av. Santa Fe 505 Piso 5

Cruz Manca, CDMX, 05349

México

interlogix.com.mx